

Microsoft Authenticator Setup on Phone

Step 1: Download the Microsoft Authenticator App to your phone

Step 2: Select to Sign in to add Work or School Account

First time opening

Subsequent openings

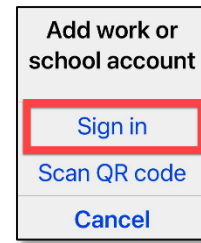
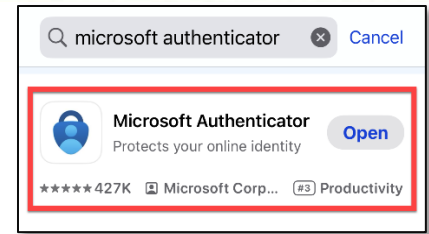
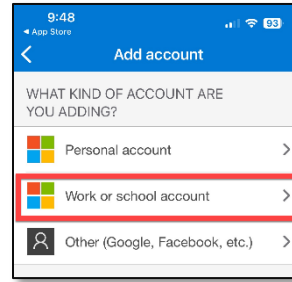
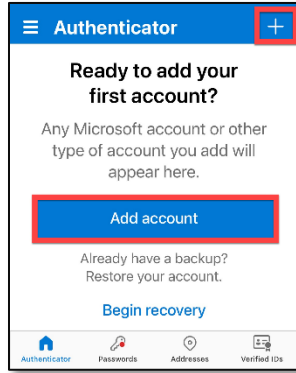
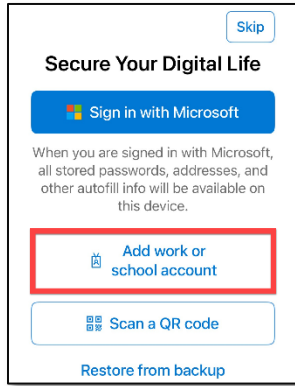

Step 3: Enter your email address and password

Step 4: Select Open browser to continue the setup process

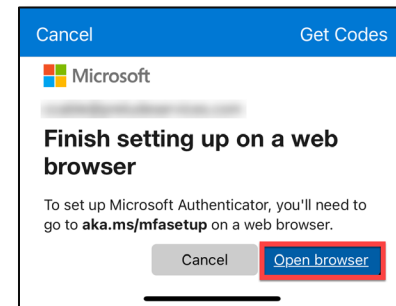
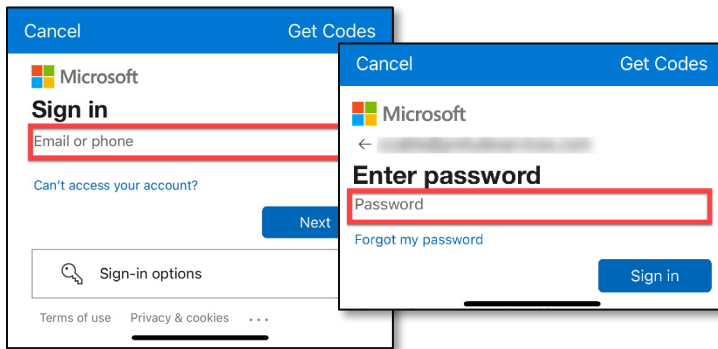

Step 5: In the browser, select Next to continue the setup process

Step 6: Select next to confirm you have the app installed

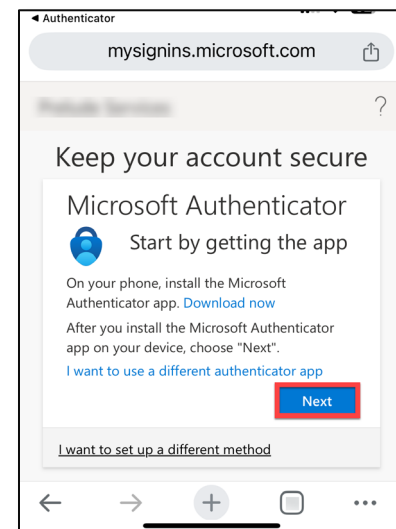
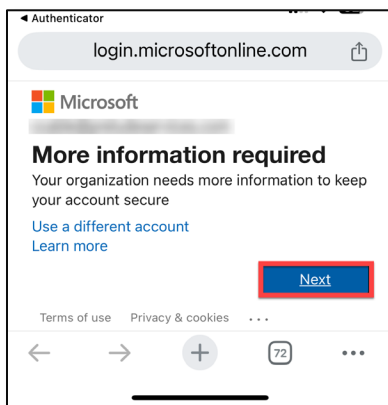

Step 7: Select the “Pair your account” link

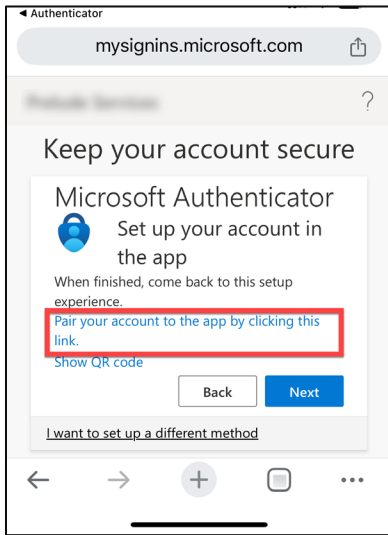

Step 8: You will be brought back into the app. Click back into your browser.

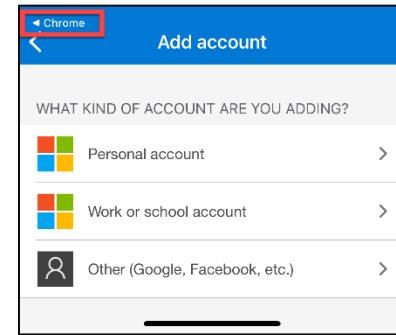

Step 9: After pairing to your app, select Next

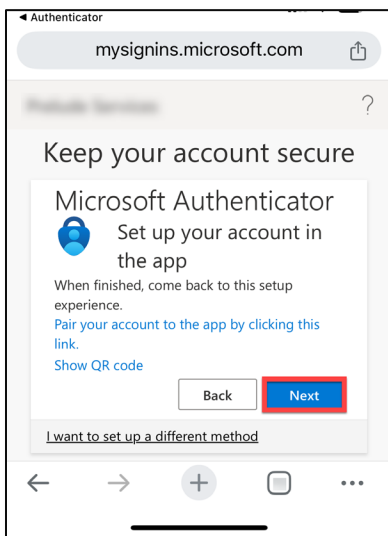

Step 10: Take note of the number shown, and click the notification to go back to the authenticator app

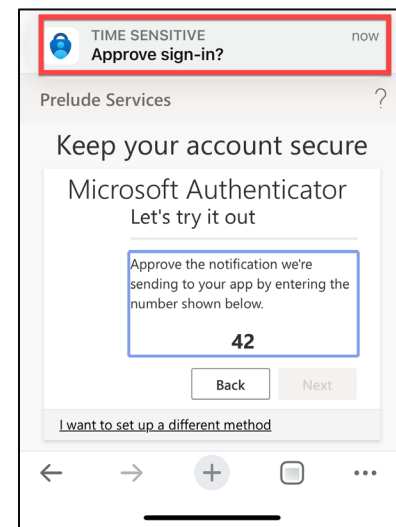

Step 11: Enter the number to confirm you are trying to sign in. Your authenticator is now set up.

